



Cordless Reel Mower

Model No. MJ420C

Form No. SJ-MJ420C-880E

A Division of Snow Joe, LLC

OPERATOR'S MANUAL

IMPORTANT!

Safety Instructions



WARNING: READ ALL INSTRUCTIONS BEFORE USE.

Read all instructions when using cordless lawn mowers. Basic safety precautions should always be followed to reduce the risk of fire, electric shock, and personal injury.

For All Lawn Mowers

1. **Avoid dangerous environment.** Do not use the mower in damp or wet locations.
2. **Don't use in rain.**
3. **Keep children away.** All bystanders (visitors) should be kept at a safe distance from work area.
4. **Dress properly.** Do not wear loose clothing or jewelry. They can be caught in moving parts. Use of rubber gloves and substantial footwear is recommended when working outdoors. Wear protective hair covering to contain long hair.
5. **Use safety glasses.** Always use face or dust mask if operation is dusty.
6. **Use right mower.** Do not use mower for any job except that for which it is intended.
7. **Don't force mower.** It will do the job better and safer at the rate for which it was designed.
8. **Don't overreach.** Keep proper footing and balance at all times.
9. **Stay alert.** Watch what you are doing. Use common sense. Do not operate mower when you are tired.
10. **Store idle mowers indoors.** When not in use, mowers should be stored indoors in dry, and high or locked-up place out of reach of children.
11. **Maintain mower with care.** Keep cutting edge sharp and clean for best and safest performance and to reduce the risk of injury. Follow instructions for lubricating and changing accessories. Keep handles dry, clean, and free from oil and grease.
12. **Check damaged parts.** Before further use of the mower, a guard or other part that is damaged should be carefully checked to determine that it will operate properly and perform its intended function. Check for alignment of moving parts, binding of moving parts, breakage of parts, mounting, and any other condition that may affect its operation. A guard or other part that is damaged should be properly repaired or replaced by an authorized service center unless indicated elsewhere in this manual.
13. **Keep guards in place and in working condition.**
14. **Keep blades sharp.**
15. **Keep hands and feet away from cutting area.**
16. **Objects struck by the lawn mower blade can cause severe injuries to people.** The lawn should always be carefully examined and cleared of all objects prior to each mowing.
17. **If lawn mower strikes a foreign object, follow these steps:**
 - i) Stop lawn mower. Remove the safety key.
 - ii) Inspect for damage.
 - iii) Repair any damage before restarting and operating the lawn mower.
18. **Use identical replacement blades only.**

Safety Instructions For Battery-Operated Lawn Mowers

1. Do not charge lawn mower in rain, or in wet location.
2. Do not use battery-operated lawn mower in rain.
3. Remove or disconnect safety key before servicing, cleaning, or removing material from the lawn mower
4. Use only the following type and size battery: type MJ420CBAT, 12V, 7Ah lead acid battery.
5. Do not dispose of the battery in a fire. The cell may explode. Check with local codes for possible special disposal instructions.
6. Do not dispose of the battery. Released electrolyte is corrosive and may cause damaged to the eyes or skin. It may be toxic if swallowed.
7. Exercise care in handling batteries in order not to short the battery with conducting materials such as rings, bracelets, and keys. The battery or conductor may overheat and cause burns.



CAUTION

The electrolyte is dilute sulfuric acid that is harmful to the skin and eyes. It is electrically conductive and corrosive. The following procedures should be observed:

- a) Wear full eye protection and protective clothing.
- b) If electrolyte contacts the skin, wash it off immediately with water.
- c) If electrolyte contacts the eyes, flush thoroughly and immediately with water. Seek medical attention.

SAVE THESE INSTRUCTIONS

Safety Instructions for Walk-Behind Mowers

GENERAL OPERATION

1. Read, understand, and follow all instructions on the machine and in the manual(s) before starting.
2. Do not put hands or feet near or under the machine. Always stay clear of the discharge opening.
3. Only allow responsible adults, who are familiar with the instructions, to operate this machine.
4. Clear the area of objects such as rocks, wire, toys, etc., which could be thrown by the blade. Stay behind the handle when the engine (motor) is running.
5. Be sure the area is clear of bystanders before operating. Stop machine if anyone enters the area.
6. Do not operate machine barefooted or while wearing sandals. Always wear substantial footwear.
7. Do not pull machine backward unless absolutely necessary. Always look down and behind before and while moving backward.
8. Never directly discharged material toward anyone. Avoid discharging material against a wall or obstruction. Material may ricochet back toward the operator. Stop the blade when crossing gravel surfaces.
9. Do not operate machine without the entire grass catcher, discharge guard, rear guard, or other safety protective devices in place and working.
10. Never leave a running machine unattended.
11. Stop the engine (motor) and wait until the blade comes to a complete stop before cleaning the machine, removing grass catcher, or unclogging the discharge guard.
12. Operate machine only in daylight or good artificial light.
13. Do not operate machine while under the influence of alcohol or drugs.
14. Never operate mower in wet grass. Always be sure of your footing; walk; never run.
15. Disengage the drive system, if so equipped, before starting the engine (motor).
16. If the machine should start to vibrate abnormally, stop the engine (motor) and check for the cause immediately. Vibration is generally a warning of trouble.
17. Always wear eye protection when operating machine.
18. See manufacturer's instructions for proper operation and installation of accessories. Only use accessories approved by the manufacturer.

SLOPE OPERATION

Slopes are a major factor related to slip and fall accidents, which can result in severe injury. Operation on all slopes requires extra caution. If you feel uneasy on a slope, do not mow it.

1. Mow across the face of slopes; never up and down. Exercise extreme caution when changing direction on slope.
2. Watch for holes, ruts, bumps, rocks, or other hidden objects. These may cause an unexpected slip or fall.
3. Do not mow on wet grass or excessively steep slopes. Poor footing could cause a slip and fall accident.
4. Do not mow near drop offs, ditches, or embankments. You could lose your footing or balance.

CHILDREN

Tragic accidents can occur if the operator is not alert to the presence of children. Children are often attracted to the machine and the mowing activity. Never assume that children will remain where you last saw them.

1. Keep children out of the mowing area and under the watchful care of a responsible adult other than the operator.
2. Be alert and turn mower off if a child enters the area.
3. Never allow children to operate the machine.
4. Use extra care when approaching blind corners, shrubs, trees, or other objects that may block your view of a child.

SERVICE

GENERAL SERVICE

1. Keep all nuts and bolts tight.
2. Never tamper with safety devices. Regularly check to ensure they are in place and working properly.
3. Keep the mower free from grass, leaves, or other debris buildup.
4. If you strike a foreign object, stop and inspect the machine. Repair, if necessary, before starting.
5. Never make any adjustments or repairs with the engine (motor) running.
6. Check the grass catcher components and the discharge guard frequently and replace with manufacturer's recommended parts, when necessary.
7. Mower blades are sharp. Wrap the blade or wear gloves, and use extra caution when servicing them.
8. Maintain or replace safety and instruction decals, as necessary.

Know Your Lawn Mower

1. Main Unit
2. Battery Pack
3. Lower Frame
4. Middle Frame x2
5. Upper Frame
6. Short Bolts with Nuts x2
7. Long Bolts with Nuts x4
8. Cable Clips x3
9. Charging Adaptor
10. Keys x2
11. Grass Collector
12. Hex Wrench

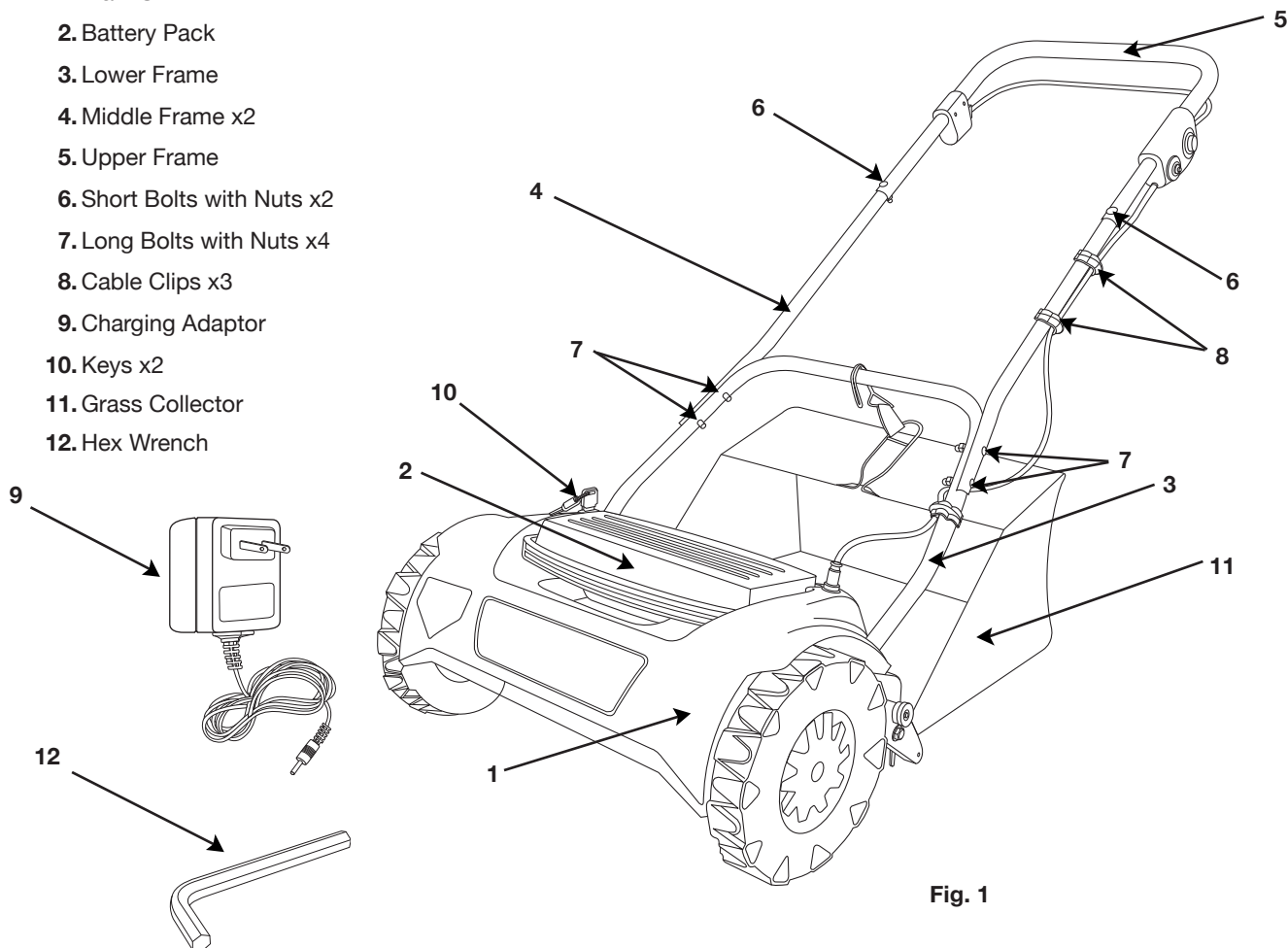

Fig. 1

Technical Data

Unit operating cycle with full battery	25 to 90 minutes*
No load speed	1200 rpm ($\pm 10\%$)
Cutting width	16 inches / 40 cm
Cutting height	0.75, 1.02, 1.46, 1.69 inches
Battery operating voltage	24V DC
Charging period for fully discharged battery	16 hours
Motor output power	54 W
Battery charger output	28.6V 800mA
Sound Power Level, LWA	94 dB(A)
Sound Pressure Level, LPA	70 dB(A)
Vibration	1.0 m/s ²
Weight	18.3 Kg (including battery)

* Dependant on grass length and thickness

Assembly

1. Fit the Lower Frame onto the two large lugs on the Main Unit. Fit one side and then flex the other side of the frame until it fits over the opposite lug. (Fig. 2 and Fig. 3)

Fig. 2

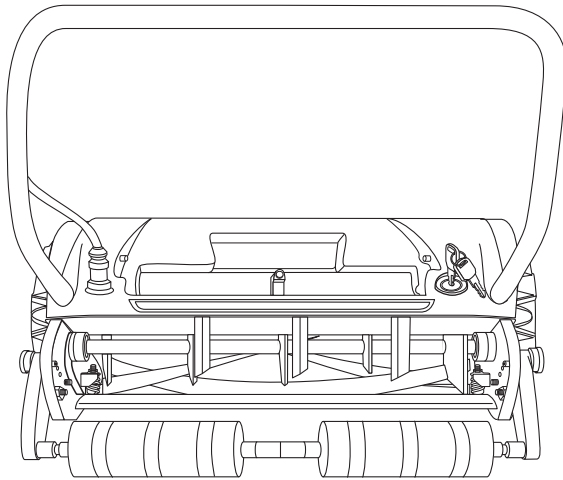
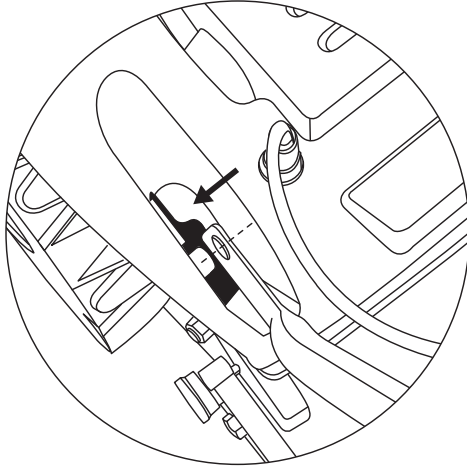
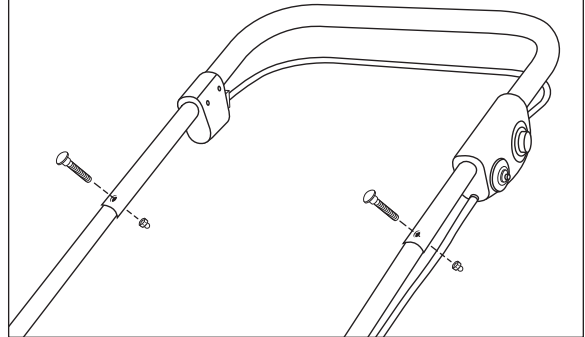

Fig. 3



2. To assemble the Upper Frame to the 2 Middle Frame parts. Hold the Upper Frame so that the Safety Lever faces downward, insert the Middle Frame sections so that they bend outwards and the holes are aligned. Insert the 2 short bolts from the top so that the nut is underneath the frame then secure each one. (Fig. 4)

Fig. 4



3. Use 4 nuts and 4 long bolts to hold the upper and middle sections in place on the Lower Frame. Insert the bolts from the outside and fit the nuts on the inside of the frame. (Fig. 5)

Fig. 5

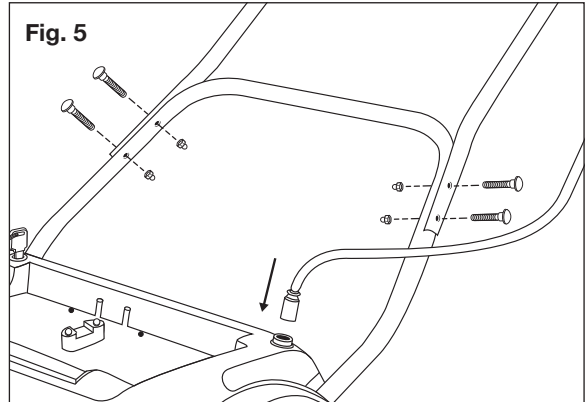

4. Once the frame is assembled, connect the plug on the handle cable to the socket on the main unit. Tighten the screw ring to secure the cable. (Fig. 5)
5. Secure the cable to the handle using the 3 cable clips, leave some slack on the cable to allow free movement. (See Fig. 1, Pg. 3)
6. To fit the Grass Collector position the hooks onto the rear roller axle of the Main Unit. (Fig. 6)

Fig. 6

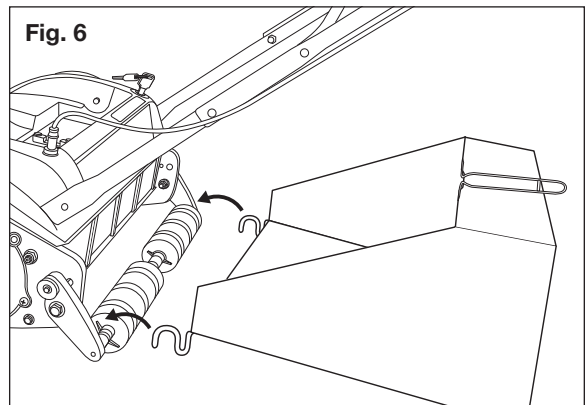

Please Note: Open grass collector fully by locking brackets in a straight position.

Safety Key

IMPORTANT!

There is a safety key fitted to this device, the product will not work without it. The key needs to be fitted and turned to the on position for the product to operate. (Fig. 7)

Always remove the key and battery before carrying out any adjustments or maintenance on the mower, or if the mower is left unattended.

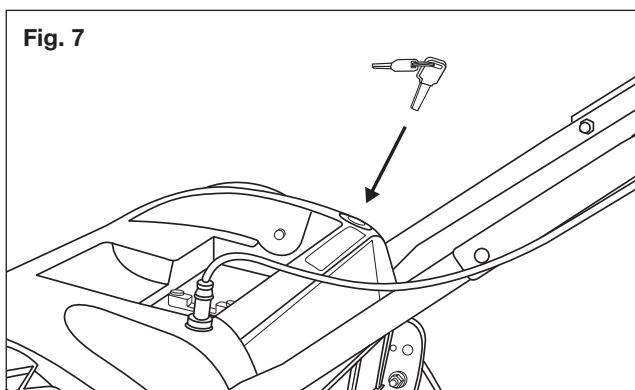

NOTE: Before first use charge the battery for 16 hours. Please refer to the section on charging and recharging.

Battery

If the battery is damaged in any way do not attempt to charge it and replace immediately.

1. Remove the battery from the product by rotating and lifting with the handle. Keep clear of any moisture, direct sunlight or temperature extremes. Fully unwind the charger cable, plug into a suitable mains outlet, the light on the charger will turn green. Fit the plug securely into the socket on the battery. The light will turn red while the battery is charging and back to green once the battery is fully charged. (Fig. 8)

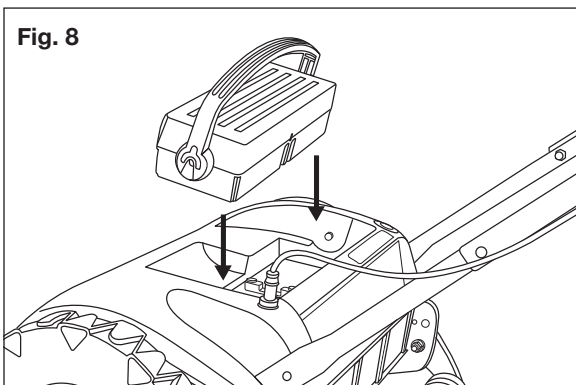

The battery requires 16 hours to charge fully from flat.

2. To refit the battery, remove the charger lead and lower it into the cavity on the top of the product in the correct orientation. If the battery does not fit correctly remove it and check there are no obstructions in the cavity. Rotate the top handle to the front of the mower to lock into position. (Fig. 9)

To keep the battery in prime condition it is best to charge the battery after each use, and every 3 months if stored.

IMPORTANT: Charge the Battery After Each Use.

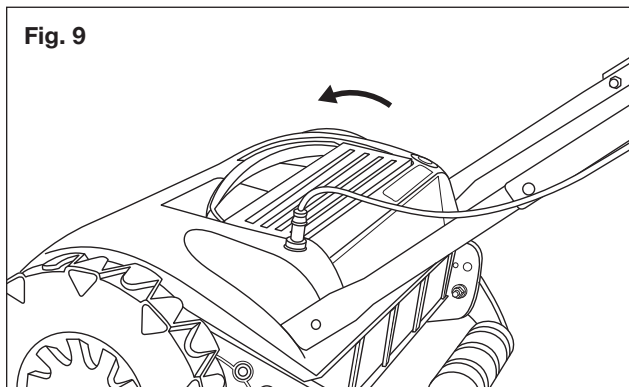

Charging Battery

Remove the Battery before charging. Do not attempt to charge the battery while in the mower.

Never store the mower with a flat Battery.

The battery should ideally be stored between 10°C and 24°C (50°F and 75°F).

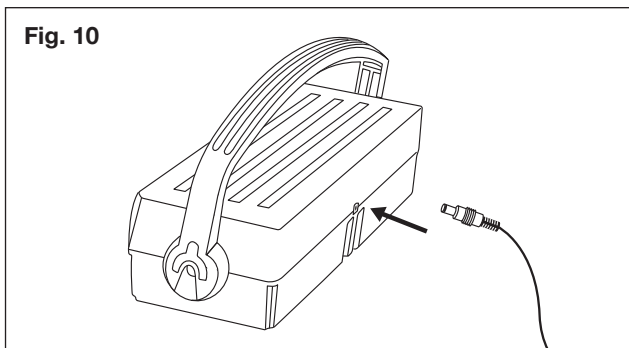

Red Light
Unit Charging

Green Light
Unit Fully Charged

The battery will not be damaged if it is charged for longer than 16 hours, but it is advisable not to leave it on for more than 48 hours, as this might shorten the battery life. (Fig. 10)

⚠ WARNING

Only use the charger supplied with this product. Do not attempt to charge this product with any other charger nor attempt to charge any other product with this charger, as it

can cause damage and will invalidate your guarantee.

USE ONLY A REPLACEMENT BATTERY AS SUPPLIED BY THE MANUFACTURER

Replacement battery can be purchased from: Snow Joe, LLC.
Please call 1-866-766-9563; Email: service@snowjoe.com;
Website: www.snowjoe.com.

Cutting Height

⚠ CAUTION:

For safety ensure that the Safety Key and Battery are removed from the Mower before adjusting the height.

To ensure that the roller is aligned correctly, it is recommended that the height is adjusted on a level surface. It is also recommended that the Grass Collector be removed as this will allow easier access to the Locking Knobs.

1. Pull out the knobs on both sides of the roller. (Fig 11)

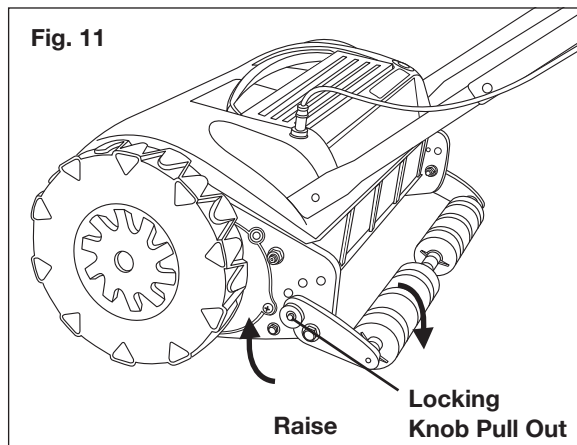

2. Holding both knobs, raise or lower the mower to the desired height.
3. Allow the knobs to spring into the holes, ensure they sit fully into the hole, are at the same height and properly secured.

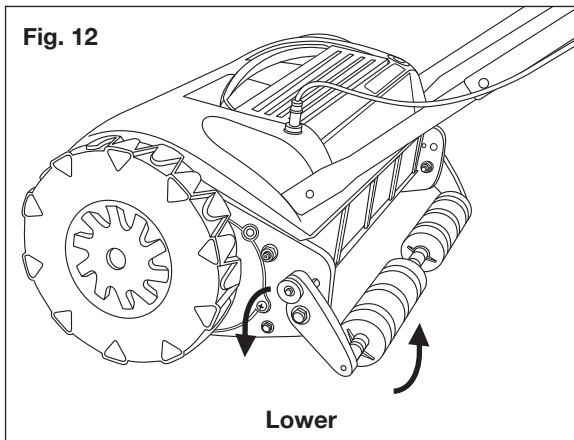

Battery Level Warning

This mower uses sealed Pb lead acid batteries, which like all batteries can be damaged if they are over-discharged. The electronic circuit will warn of low battery level and RED LED will be on, this indicates that the battery should be recharged at this point.

GREEN LED ON—Normal operation.

RED LED ON—Battery flat, please charge to prevent over discharge damage.

Blade Adjustment

SHARP BLADES – BE VERY CAREFUL.

⚠ CAUTION:

For safety ensure that the Safety Key and Battery are removed from the Mower before adjusting the blade.

To adjust the blade turn the 2 bolts on the blade shield. The cylinder should almost touch the blade, but do not over tighten it. (Fig.13)

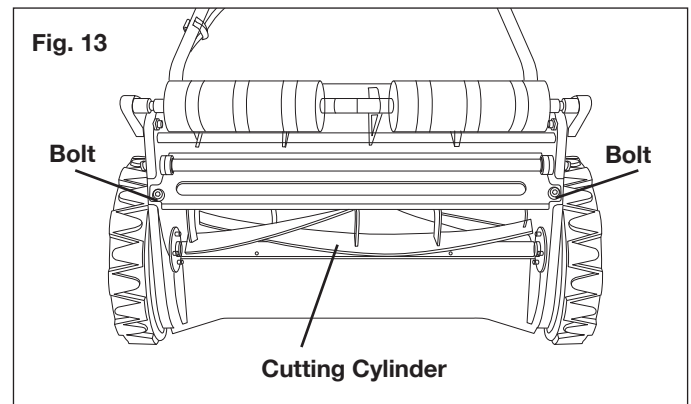

If the cylinder hits the blade, it is too tight and will damage the cutting edge; loosen the nuts.

To check for correct adjustment, insert a piece of paper between the blade and the cutting cylinder. When the cutting cylinder is turned by hand the paper should be cut cleanly. (Fig. 14)

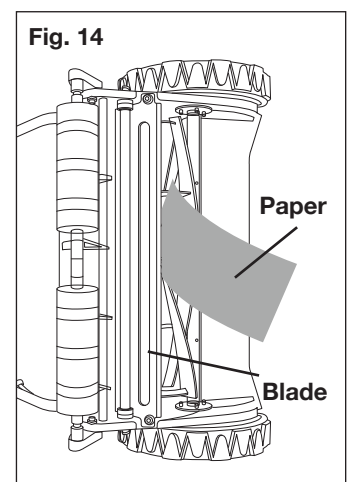

Mowing Tips

Before mowing ensure the area to be cut is clear of stones or other objects, which may damage the mower or cause injury.

Start by mowing around the edges of your lawn, then cut the center area in stripes. (Fig. 15) Mow twice a week during growing season, the grass will be weakened if more than a third of the length is cut away at one time. The mower should be parked, the operation lever released and the blades allowed to stop before the grass collector is removed for emptying.

Do Not Overload the Mower

If you hear the motor in the mower change pitch dramatically while mowing, it may be overloaded.

If the grass is very thick or long, a first cut with the cutting height set higher will help reduce the load on the motor. (See Cutting Height section on page 6)

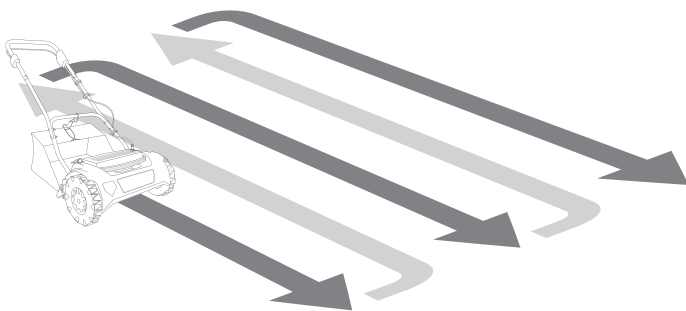

Fig. 15

Emptying the Grass Collector

Before removing the grass box for emptying, release the operation lever and wait for the blades to stop turning.

1. Lift the basket up and toward the mower to release the hooks.
2. Lift up and clear of the mower. Always empty clippings before storage.
3. Replacing the grass collector is the reverse of the removal process.

Starting & Stopping

The handle is designed with a safety button to prevent accidental starting.

1. Press and hold the safety button 'A' located on the left of the upper handle, then squeeze the operation lever 'B' towards the upper handle. You can now release the safety button (A) and Start Mowing (Fig. 16)

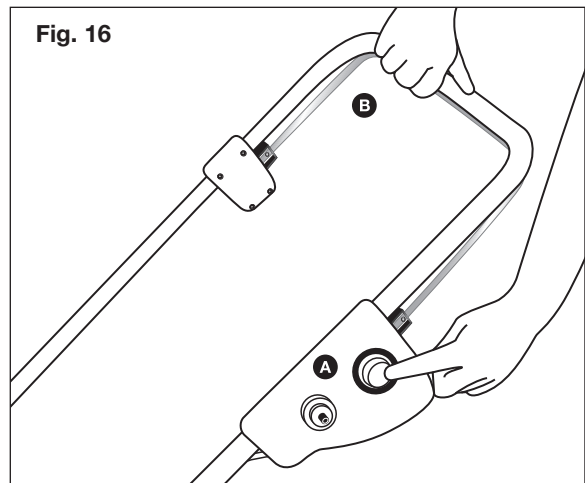

Fig. 16

2. Release the operation lever 'B' to stop the mower. (Fig. 17)

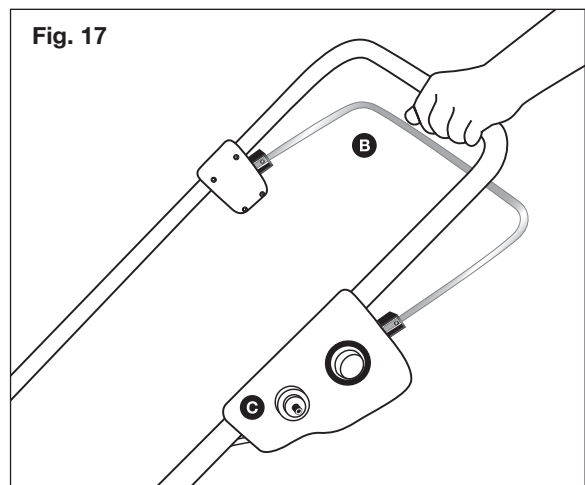

Fig. 17

⚠ IMPORTANT: When releasing the operation lever, wait for the blades to stop turning before clearing any grass or putting your hands near the blades!

Over Work Protection

The reset button 'C' (Fig.17) on the switch box is to prevent any damage occurring to the battery or the motor due to a current overload, such as from the blade jamming. If the load exceeds its capacity the reset button will pop out and stop the power supply to protect the mower and blades.

To restart the mower

Ensure the blades are clear of debris, wait for a few seconds, then press the reset button.

Please Note: Cutting long, thick, or wet grass could overload the mower or make the blade stall. If the over work protection

operates then the following actions are recommended:

1. Make a first higher cut then make a second cut with the required cutting height.
2. Check the blade is correctly adjusted so the grass is cut cleanly.

Fig. 18

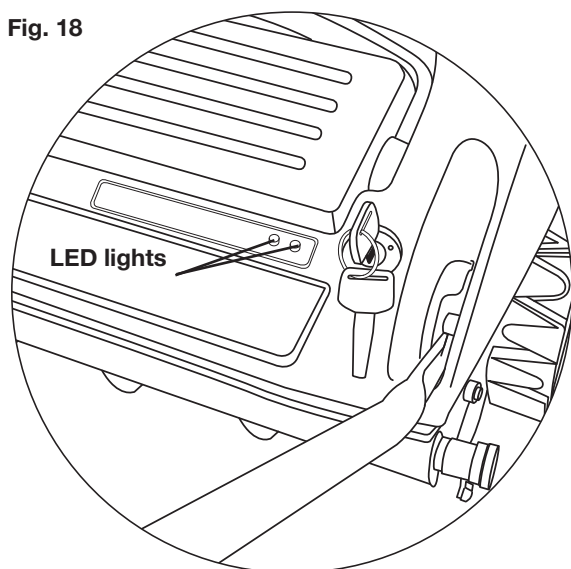

Environment

When the time comes to dispose of this product please consider the environment and take it to a recognised recycling facility instead of disposing with general household waste.

The mower contains a sealed lead acid (Pb) battery which must be disposed of properly.

Call your local council, civic amenity site, or recycling centre for information on the recycling and disposal of electrical products and lead acid (Pb) batteries.

FAQ

Why does my mower stop?

Make sure the battery is charged, properly seated and locked in position. Ensure the key is fitted and in the ON position.

The reset button is preventing damage from overload, allow a few minutes for the mower to cool clear any debris and resume.

Press the reset button and hold the operation lever up to restart the mower.

Where should I keep my battery?

The battery should ideally be stored between 10°C and 24°C (50°F and 75°F) so the best place would be inside your house or garage. **IMPORTANT: Charge battery after each use.**

My lawn is very hard to cut, what can I do?

Cut the grass more often to keep it shorter. Ensure the mower is maintained correctly. Do a high cut before cutting the grass short. Ensure blades are adjusted correctly. Charge the battery.

My mower is noisy or won't cut the grass.

Check the blades are correctly adjusted to give a clean cut.

How can I get my mower repaired if it is damaged?

Please call 1-866-766-9563 for assistance

Where do I find my serial number?

In front of the main unit and under the battery.

What is your returns policy?

See inside cover of manual.

Care and Maintenance

⚠ CAUTION: Remove the key and Battery before carrying out any maintenance. Do not accidentally turn the unit on while cleaning it.

- Check for any faults such as loose or damaged blades, loose fittings and worn or damaged components. Ensure the mower is in full working order before operating it.
- Check that covers and guards are correctly fitted and are not damaged in any way.
- Carry out any repairs before using the lawn mower again.
- Clean the lawn mower using a soft brush or cloth.
- Do not use abrasive materials to clean the product or immerse it in water.
- Don't use on wet ground.
- Don't allow pieces of string, rope, stones or fabrics to enter the unit.
- Beware of raised areas such as paving stones or manhole covers that can damage the blades.

Storage

Before storing, remove the Safety key and Battery. Turn the machine on its side and clean the blade area. If grass cuttings are compacted in the blade area, remove with a wooden or plastic implement. Remove all grass and debris.

- Clean the exterior of the machine thoroughly using a soft brush or cloth.
- Do not use water, solvents or polish.
- Store the lawn mower in a dry place and oil the blades.
- Do not place other objects on top of the machine.

For storage in confined spaces the handles can be removed from the mower. Disconnect the power cord and flex the lower handles to remove from the frame locating lugs.

Never Store the Mower With a Flat Battery. The battery should ideally be stored between 10°C and 24°C (50°F and 75°F).

To keep the battery in prime condition it is best to charge the battery after each use, and every 1–3 months if stored. After each use charge for 16 hours to ensure the battery is fully charged.

IMPORTANT: Charge the battery after each use.

Service and Support

If your Lawn Mower requires service or maintenance, please call 1-866-766-9563 for assistance.

Model and Serial Numbers

When contacting the company or reordering parts, you will need to provide the model and serial numbers of your product. These are found on the decal affixed to the housing or handle of your Cordless Reel Mower. Copy these numbers into the space provided below.

Record the following numbers from the housing or handle of your new product:	
Model #:	
	M J 4 2 0 C
Serial #:	



A Two-Year Full Warranty for residential use in the United States and Canada



General Conditions:

Snow Joe, LLC warrants this product to the original purchaser for two years against defects in material or workmanship when used for normal residential purposes. Snow Joe, LLC will repair any defect in material or workmanship, and repair or replace any defective part, subject to the conditions, limitations, and exclusions set forth herein. Such repair or parts replacement will be free from charge to the original purchaser except noted below.

The duration of the warranty applies only if the product is put to personal use around the household or residence. If the product is put to any business use, commercial or industrial, then the duration of this warranty is 90 days from the date of original purchase. If any product is rented or leased, the duration of the warranty is 90 days from the date of original purchase.

It is the owner's responsibility to perform correctly all maintenance, and minor adjustments explained in the owner's manual.

Electric Products:

To obtain a replacement electric powered unit or repair the existing electric powered unit, you must return the complete unit and postage prepaid to: **Snow Joe Return Center, 86 Executive Avenue, Edison, NJ 08817.**

Gasoline / Battery Products:

Limitations

- Batteries are warranted only for the period of 12 months after the date of purchase on a prorated basis. Rechargeable batteries will be replaced free from charge during the first 90 days. After the initial 90 days, batteries will be replaced at prorated cost to the customer
- Idlers, cables, and electrical components are warranted to the original purchaser for use at household or residence for a period of two years

Exclusions

- Snow Joe brand engines are covered under this warranty. All other engines and engine accessories are covered only by the engine manufacturer's warranty and are not covered by this warranty
- Parts used that are not genuine Snow Joe parts are not covered by this warranty
- Damages resulting from misuse, alteration, improper assembly, improper adjustment, neglect, or accident which requires repair is not covered under this warranty
- Belts, augers, and tines are not covered under warranty – belts, augers, and tines wear out and can be purchased at www.snowjoe.com or by calling 1-866-766-9563

Snow Joe, LLC may from time to time change the design of its products. Nothing contained in this warranty shall be construed as obligating Snow Joe, LLC to incorporate such design changes into previously manufactured products, nor shall such changes be construed as an admission that previous designs were defective.

This warranty is intended to cover product defects only. Snow Joe, LLC is not liable for indirect, incidental, or consequential damages in connection with the use of the Snow Joe Products covered by this warranty. This warranty does not cover any cost or expense incurred by the purchaser in providing substitute equipment or service during reasonable periods of malfunction or non-use of this product, while waiting for completion of repairs under this warranty. Some states do not allow exclusions of incidental or consequential damages, so the above exclusions may not apply in all states. This warranty may give you specific legal rights in your state.

**If you wish to contact Snow Joe, please direct inquiries to the:
Customer Service Department
Snow Joe Center
86 Executive Avenue
Edison, NJ 08817**

Customers who have purchased Snow Joe products exported from the United States and Canada should contact their Snow Joe Distributor (Dealer) to obtain information applicable for your country, province, or state. If for any reason, you are not satisfied with the distributor's service, or if you have difficulty obtaining warranty information, contact your Snow Joe seller. If in the event your efforts are unsatisfactory, please write to the Snow Joe Center at the above address.

If you have any questions about your product warranty, please call 1-866-SNOW-JOE or visit us online at www.snowjoe.com.